

# Northern Line Extension

## Core Community Liaison

## Group meeting

## 28.10.15

Delivering the Northern line extension with

ferrovial  
agroman



MAYOR OF LONDON



TRANSPORT  
FOR LONDON



# NLE Project Draft timetable

| Year | Key milestones  |
|------|---|
| 2014 | Transport and Works Act Order decision,<br>Design & Build contract signed                                     |
| 2015 | Agreement on Code of Construction Practice Part B,<br>Start of main works at all sites                        |
| 2016 | Assembly of Tunnel Boring Machines  |
| 2017 | Completion of tunnelling  |
| 2018 | Fit out of new stations, Kennington shafts complete inc<br>reinstatement, work at Kennington station complete |
| 2019 | Testing, commissioning, trial operations  |
| 2020 | NLE complete and in service   |



# Kennington Green Jun – Sep 2015

- Continuation of utilities works
  - ✓ Thames Water Main works taking place
  - ✓ Virgin Media works taking place
- Piling Mat construction
- Demolition Chivas Headwall
- Tree works
- Permanent hoarding commenced
- Pre-Construction Defect Surveys and monitoring



# Kennington Green Oct - Dec 2015

- Installation of guide walls
- Commencement Secant Piling
- Service diversions for BT and Virgin media
- Tree works continuation
- SGN Gas Main works
- On - going Pre-Construction Defect Surveys
- On-going monitoring installation on identified locations





# Temporary Noise Enclosure KG



FERROVIAL AGROMAN  
LAING O'ROURKE JV

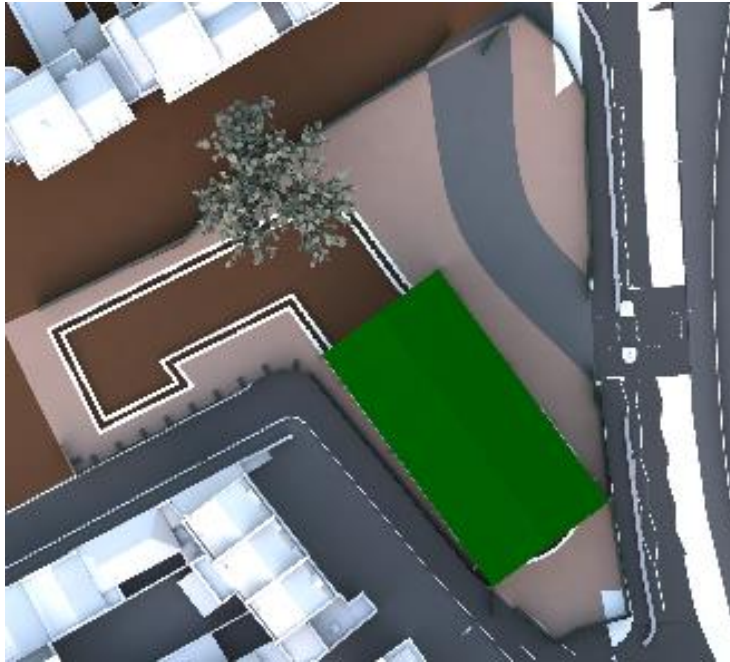

# Kennington Park Jun – Sep 2015

- Ongoing SGN Gas Diversion
- Commenced secant piling
- Site Accommodation set-up



# Kennington Park Jun – Sep 2015



FERROVIAL AGROMAN  
LAING O'ROURKE JV



# Temporary Noise Enclosure KP

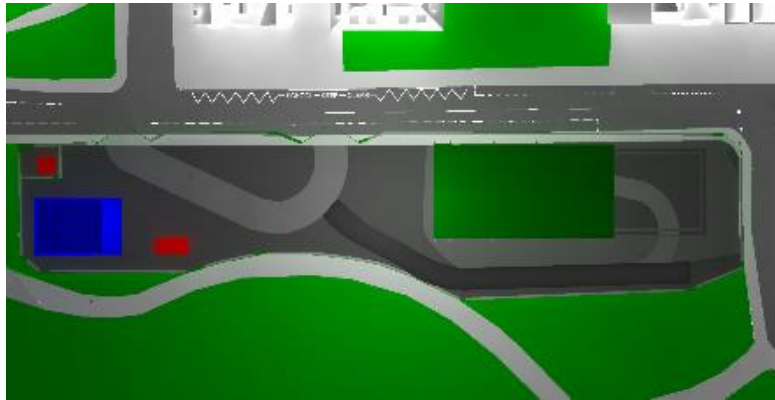



# Nine Elms June – Sept 2015

- Demolition of Banham's building
- Installation of hoarding and scaffold erection at the front of Banham's building
- Obstruction removal and build of piling platform and guide wall
- Piling enabling works (bentonite plant construction)
- Piling works in former Sainsbury's car-park
- Exit gate in Pascal Street for site traffic
- Hoarding graphics installed to TfL standards

# Nine Elms June – Sept 2015



1) Bentonite Plant



2) Banhams Demolition works



3) Piling activities

# Nine Elms Oct - Dec 2015

- Continue piling works
- Completion of demolition activities Banhams building
- Heavy plant arriving on site
- Continuing with obstruction removal and prep works for piling (piling platform construction and guide walls)
- New office cabins fully operative
- On - going pre-construction defect surveys
- On-going monitoring installation



# Piling activities at Nine Elms

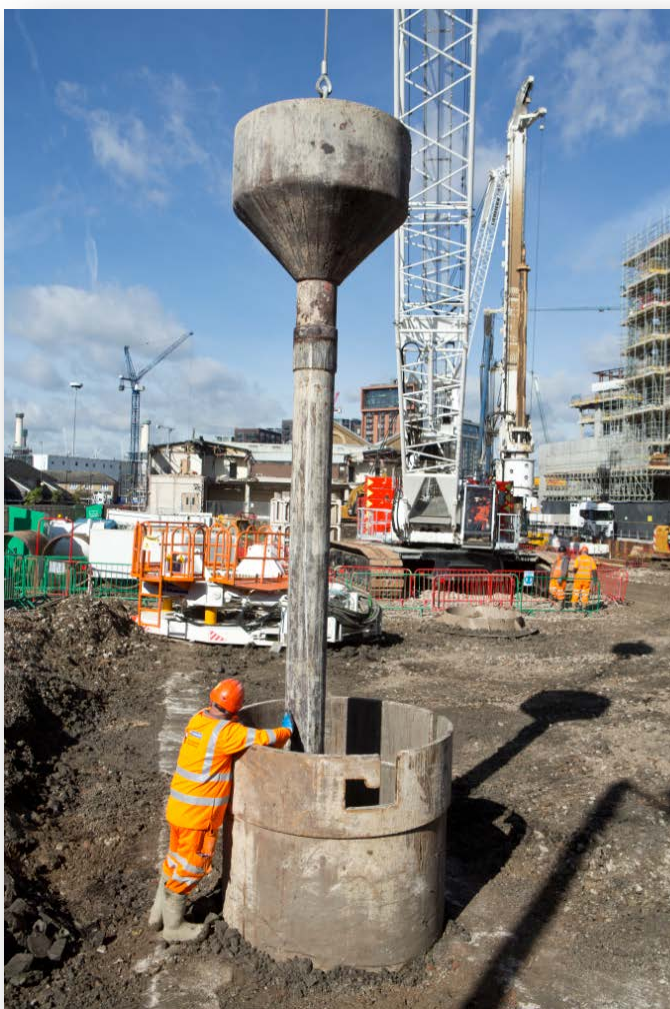

Concrete pour on going

## FACTS:

- Number of piles: 350 nr.
- Excavated material (m<sup>3</sup>): 27,500
- Concrete used (m<sup>3</sup>): 24,000
- Reinforced steel (tons): 2,600
- 2nr Crawler cranes (160t & 100t)
- 2nr Piling Rigs (180t & 160t)

# Battersea Jun – Sep 2015

- Setting up Conveyor for muck away
- Crossover box obstruction removal and piling mat installation
- Setting up new office accommodation
- Preparation for diaphragm walling activities
- Crawler crane arrival
- On - going survey and monitoring railway infrastructure



# Battersea Jun – Sep 2015



FERROVIAL AGROMAN  
LAING O'ROURKE JV



# Battersea Oct - Dec 2015

- Continue diaphragm piling
- Bentonite Plant / Heavy plant arriving on site
- Completion of utilities diversion
- New entrance completed. Signalised junction in place
- New office cabins fully operative
- Barge operations start
- On - going pre-construction defect surveys
- On-going monitoring installation



# Conveyor and Barge movement



- Installation of footbridge
- Existing grade 2 listed bridge removed
- Core Hours Loading
- During Tunnelling, 24/7
- Two 500t barges = 50 lorries



# Your Feedback



AGROMAN  
OURKE JV

## You Suggested

## We Did

Access control through Pascal St on Sunday for Market

Gate have been reinstated to manage access

More diligence and coordination for Traffic Management Issues

Bi-weekly open meetings between TfL surface, authorities, NLE and community

Opportunities for local businesses

LEAP group is progressing. Site canteen at Nine Elms and Battersea run by local business

Concerns regarding the delivery of information to vicinity

We have reviewed and updated contact list

Engagement Meetings

Flo have had two drop in sessions at Kennington area in September / Cycling event on October 15 with BPSDC

Integrated meetings with major developments in the area

NLE and Tideway are joining their CLG meetings. BPSDC on same date every 6 months

Collaboration requested for WE landscaping scheme

FLO is looking at co-funding the project



# Engagement Opportunities



- Community Liaison Groups
- Drop-in sessions
- Engagement Sessions
- Cycle safety Events
- Charity initiatives



# NLE Skills and Employment



FERROVIAL AGROMAN  
LAING O'ROURKE JV

SLNT Plan has been approved

NLE awarded by BEST for their work experience contribution

Speed mentoring activities

December 2015 Career Event

Pipeline of activities for apprentices during 2016



# Ways to contact us

- It is important that calls are logged through the NLE 24/7 helpdesk on 0343 222 2424
- Email [nle@tfl.gov.uk](mailto:nle@tfl.gov.uk)
- Regular Drop In sessions
- Please visit:

<https://tfl.gov.uk/northern-line-extension>