

**Date: 7 July 2015**

**Item: Accessibility Schemes at Crossrail Surface Stations**

---

**This paper will be considered in public**

**1 Summary**

- 1.1 The accompanying presentation provides an overview of the proposals for improving accessibility at seven surface Crossrail stations.
- 1.2 The presentation covers the following areas:
- (a) an overview of accessibility at the Crossrail stations within the central area; the surface section and the seven smaller surface stations;
  - (b) the cost of completing the works and the funding which has been agreed for these;
  - (c) the delivery timetable for the works at the stations on the Great Western and Great Eastern routes;
  - (d) the synergies of these works with other Crossrail station works; and
  - (e) the outline designs for the work to be completed at Seven Kings, Manor Park, Maryland, Hanwell, Iver, Langley and Taplow stations.
- 1.3 This paper and presentation were presented to the Rail and Underground Panel at its meeting on 20 May 2015.

**2 Recommendation**

- 2.1 The Panel is asked to note this paper and presentation.

**List of appendices to this report:**

Appendix 1: Accessibility Schemes at Crossrail Surface Stations presentation

**List of Background Papers:**

None

Contact Officer: Howard Smith, Operations Director, Crossrail  
Number: 020 3197 5976  
Email: Howard.Smith@tfl.gov.uk



# ◀ Accessibility Schemes at Crossrail Surface Stations

◀ Howard Smith,  
Operations Director  
Crossrail

## ◀ Background

- ▶ New Crossrail stations in the central area are being constructed step free street to platform
- ▶ The majority of the stations on Crossrail's surface sections (to Shenfield and Reading) are step free already - or will be made step free as they are rebuilt as part of Crossrail project works
- ▶ Until recently, there were no plans to make seven smaller surface stations step free

## ◀ Funding Agreement

- ▶ The affected stations are
  - ◆ Great Eastern: Seven Kings, Manor Park, Maryland.
  - ◆ Great Western: Hanwell, Langley, Iver, Taplow.
- ▶ The cost of installing lifts at these stations is £33m
- ▶ At the end of 2014 TfL announced that it would fund step free provision at the four stations in the GLA area at a cost of £19m
- ▶ DfT has agreed to fund provision at the three stations outside the GLA area at a cost of £14m
- ▶ The announcements were greeted with widespread borough and stakeholder support

## ◀ **Delivery – Great Eastern**

- ▶ Feasibility and design work has been undertaken and the first contracts will be let in Autumn 2015
- ▶ The intention is to complete the three stations on the Great Eastern by mid 2017
- ▶ This coincides with the introduction of the new Crossrail rolling stock and launch of Crossrail branded services
- ▶ The two new bridges are planned to be installed in January 2017 during a closure of the line for other works

## ◀ Delivery – Great Western

- ▶ After completing the Great Eastern works the focus will be on the Great Western where TfL takes over the stations in December 2017 prior to the introduction of Crossrail services in 2018-19
- ▶ Works will take place at the four Great Western stations and will be completed by November 2019, just prior to the introduction of Crossrail services to Maidenhead and Reading in December 2019

## ◀ Synergies with Other Station Works

- ▶ The accessibility works form part of a wider, funded, £93m project to repair, refurbish and upgrade 22 Crossrail surface stations
- ▶ This wider project includes renovation and remodelling of station buildings, new lighting, and waiting facilities and improved and enlarged public areas
- ▶ This wider work is being undertaken to the same timescales as the accessibility works

## ◀ Outline Designs

- ▶ The following slides show, diagrammatically, how lifts and ramps will be added to the seven surface stations
- ▶ These are illustrative, Computer Generated Images (CGIs) of engineering designs, not architectural representations of how the structures will look



## ◀ Seven Kings

New bridge to serve persons with reduced mobility

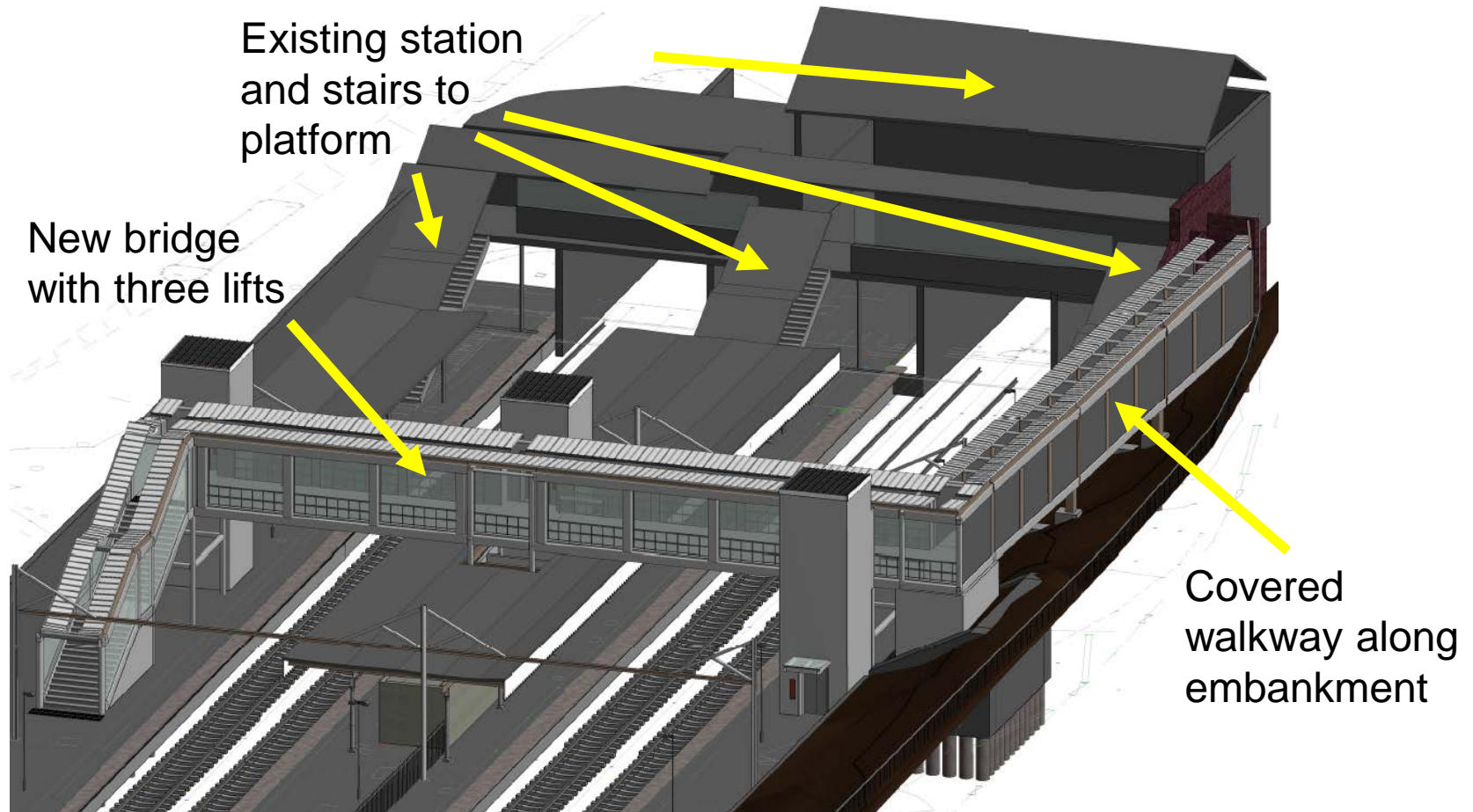

## ◀ Manor Park

New bridge with lifts used by all passengers



# ◀ Maryland

New lifts installed within existing station

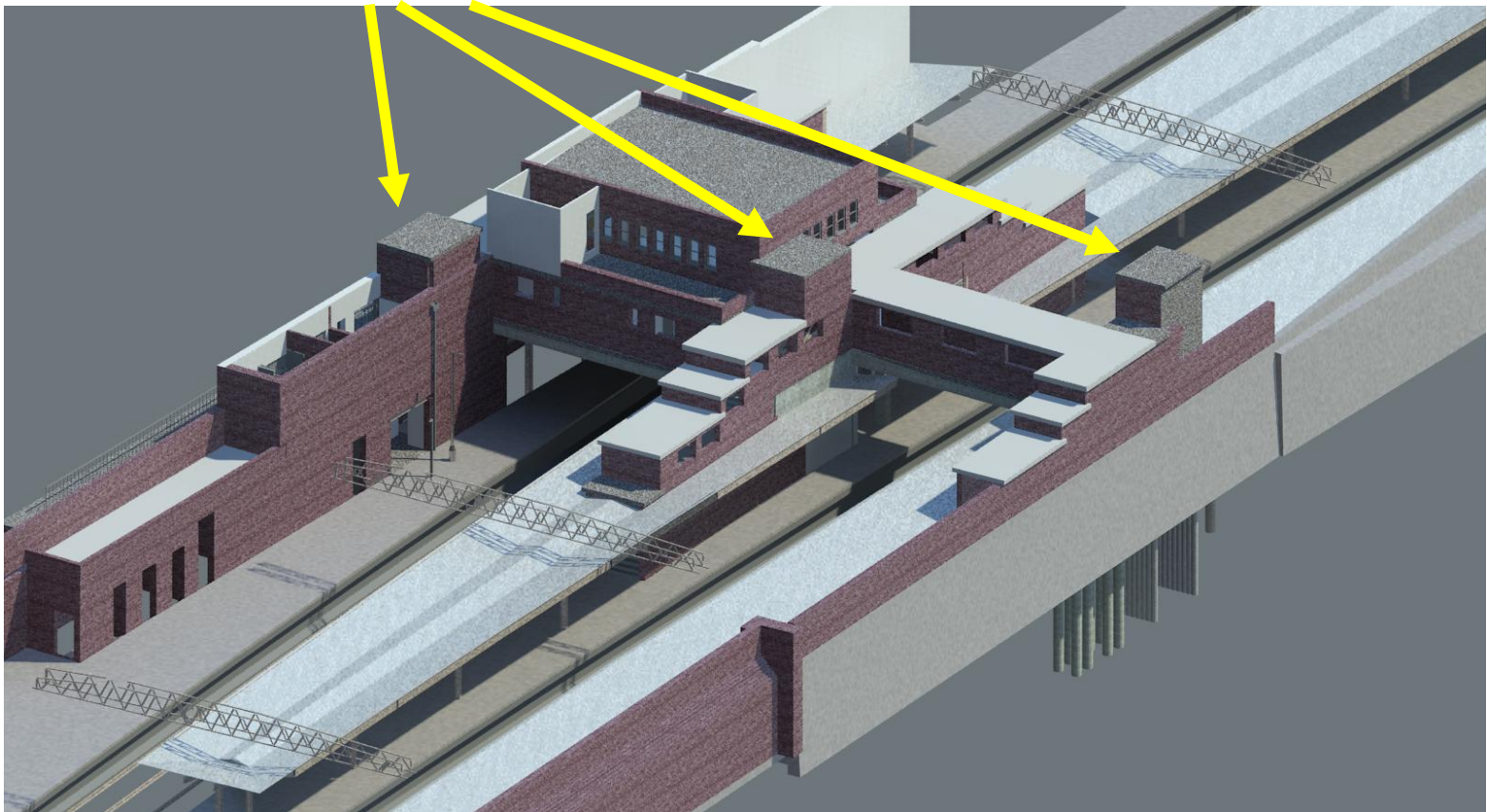

## ◀ Hanwell – North side

New lift tower agreed



# ◀ Hanwell – Island platform

New lift under listed canopy



# ◀ Iver

New lifts on existing bridge to Crossrail platforms

Ramp up to bridge  
(and down to fast lines  
for occasional use)

PRM  
entrance

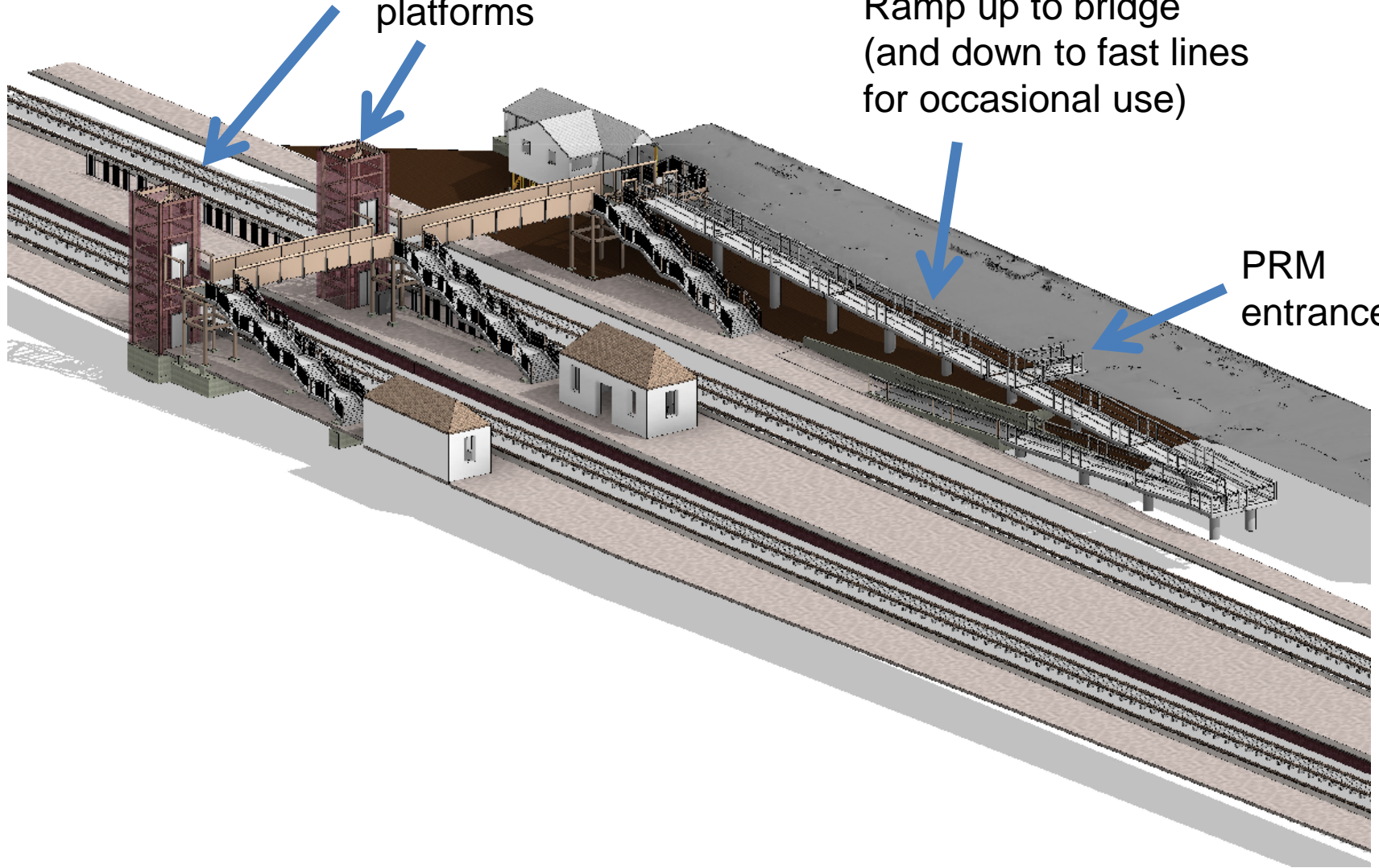

# ◀ Langlely

New footbridge plus lifts to all platforms

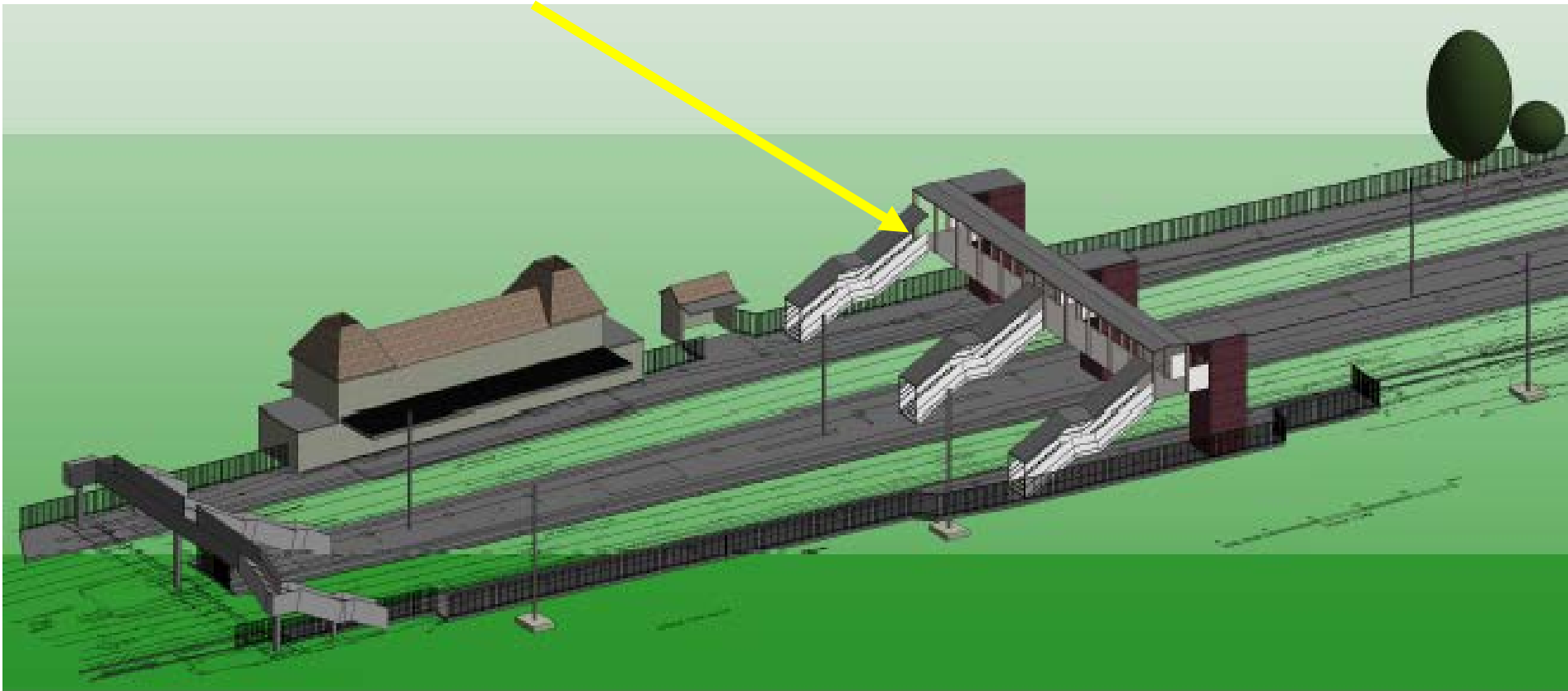

## ◀ Taplow

New footbridge to Crossrail platforms. Fast lines not operational at this station





## ◀ Summary

- ▶ The provision of joint funding by TfL and DfT means that the whole Crossrail route will now be accessible from street to platform
- ▶ The announcement was very well received by stakeholders as helping to ensure that Crossrail, as part of TfL's network, is a truly world class railway
- ▶ Works will be undertaken on the Great Eastern route 2016-17 and the Great Western route 2017-19 prior to the introduction of Crossrail services



**MOVING LONDON FORWARD**